

There are lots of different steps to remember when changing fractions, decimals and percentages and it can be hard for students to remember each one.

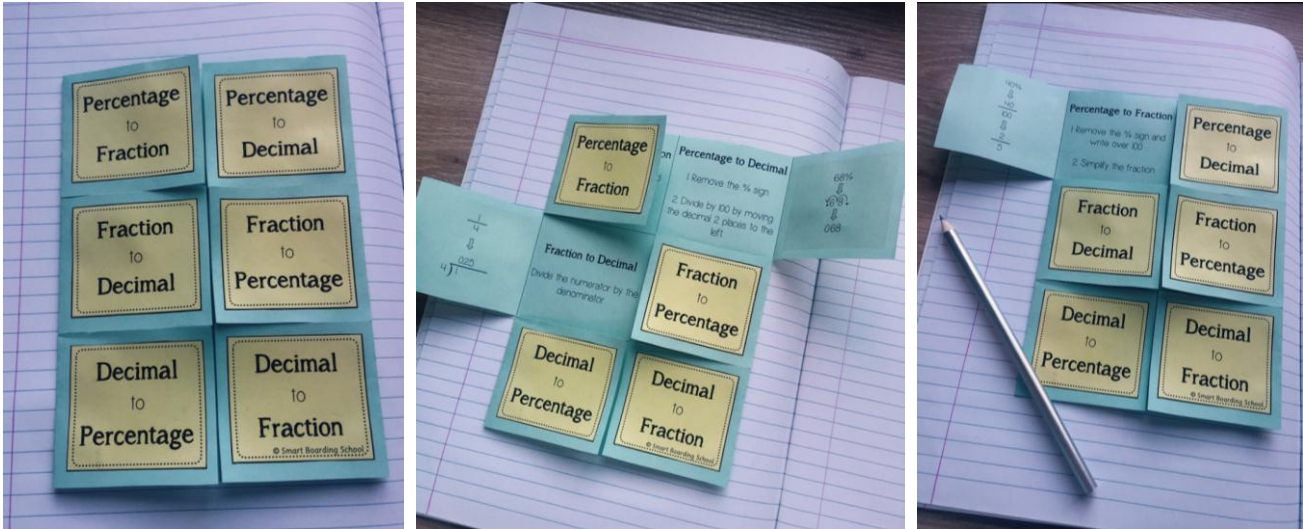

Use this printable, to give students a step by step instruction for converting fractions, decimals and percentages, which they can quickly refer back to in their interactive notebook.

This free product is for personal use in a classroom or home use only, by one teacher or family. If you intend to use this product for more than one classroom or home, please return to [Smart Boarding School](https://www.smartboardingschool.com) to download additional copies. I depend on site visits to be able to provide you with these free resources.

You may not share this resource, sell this resource, or copy this resource for distribution other than classroom use. However please refer others to download the resource at [Smart Boarding School](https://www.smartboardingschool.com).

All rights for this product remain with [Smart Boarding School](https://www.smartboardingschool.com).
Copyright © [Smart Boarding School](https://www.smartboardingschool.com)

Cut out each of these labels and glue them on the back of the first and last columns on page 3 as shown in the above photo.

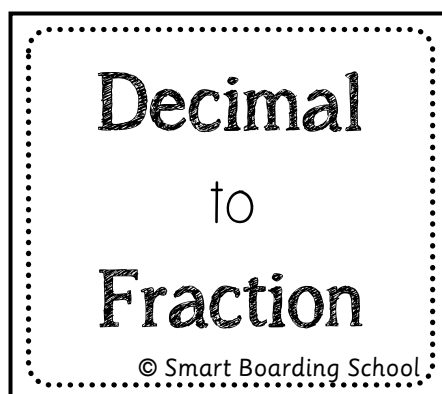
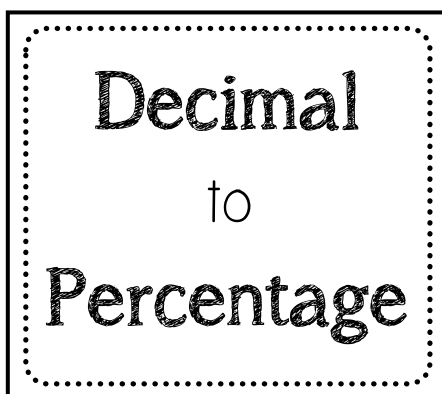
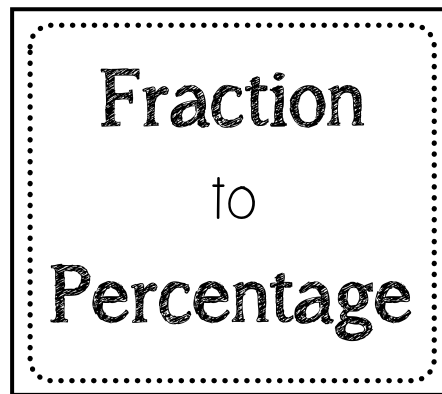
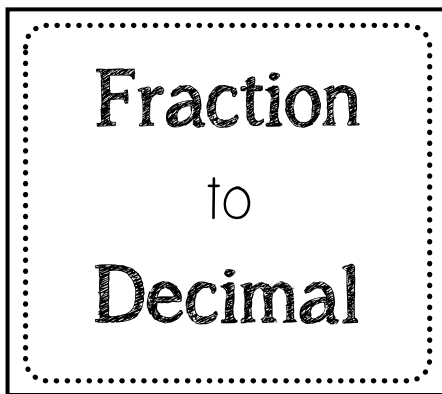
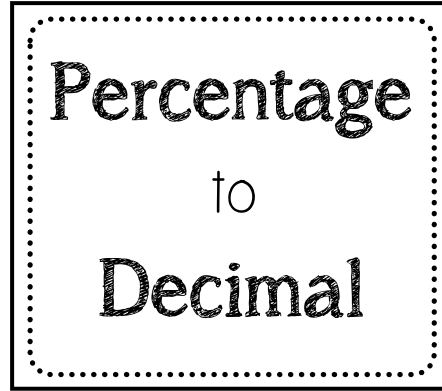
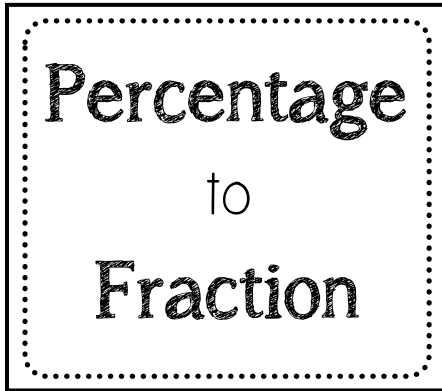

Instructions for Page 3:

Cut along the grey lines and fold the solid lines.

Glue labels on the back of these columns

40% \downarrow $\frac{40}{100}$ \downarrow $\frac{2}{5}$	<p>Percentage to Fraction</p> <p>1. Remove the % sign and write over 100</p> <p>2. Simplify the fraction</p>	<p>Percentage to Decimal</p> <p>1. Remove the % sign</p> <p>2. Divide by 100 by moving the decimal 2 places to the left.</p>	68% \downarrow $\overline{)68.}$ \downarrow 0.68
$\frac{1}{4}$ \downarrow $4 \overline{)1.00}$	<p>Fraction to Decimal</p> <p>Divide the numerator by the denominator.</p>	<p>Fraction to Percentage</p> <p>1. Convert the fraction to a decimal.</p> <p>2. Times by 100 by moving the decimal 2 places to the right</p> <p>3. Add the % sign</p>	$\frac{1}{2} = 0.5$ \downarrow $\overline{)50.}$ \downarrow 50%
0.68 \downarrow 68%	<p>Decimal to Percentage</p> <p>1. Times by 100 by moving the decimal place 2 places to the right.</p> <p>2. Add the % sign</p>	<p>Decimal to Fraction</p> <p>1. Write the decimal over 10 if it has an integer in the tenths place, over 100 if the integer is in the hundredths place.</p> <p>2. Simplify the fraction</p>	0.6 \downarrow $\frac{6}{10}$ \downarrow $\frac{3}{5}$